

Absorgel Max



absorbs
300%*



- ✓ high moisture absorption
- ✓ no liquid water collection
- ✓ for high loaded containers
- ✓ no loss of cargo space
- ✓ rapid absorption during shorter voyages
- ✓ protects loads throughout their journey
- ✓ suitable for bulk loaded or tightly packed containers

Absorgel Max is based on the proven ability of calcium chloride to aggressively remove moisture from the air. The absorbed water is bound into a gel so no liquid is formed, preventing leakage.

The Absorgel Max is designed to hang from the lashing rings below the container ceiling. The unit is easy to install and remove using the AbsorHook System.

How Absorgel Max works

Absorgel Max begins working immediately once removed from its transparent sealed packaging. It is easy to install and remove. No ladder is needed, saving you time, effort and money.

The calcium chloride absorbs moisture from the surrounding air that passes through the outer breathable packaging material. The viscous gel ensures absorbed moisture is trapped in the product and can not leak or re-evaporate.

Typical Applications

The Absorgel Max is especially suitable when the cargo is high loaded close to the container ceiling and walls.



*Absorption rate refers to ability to absorb based on the products weight.



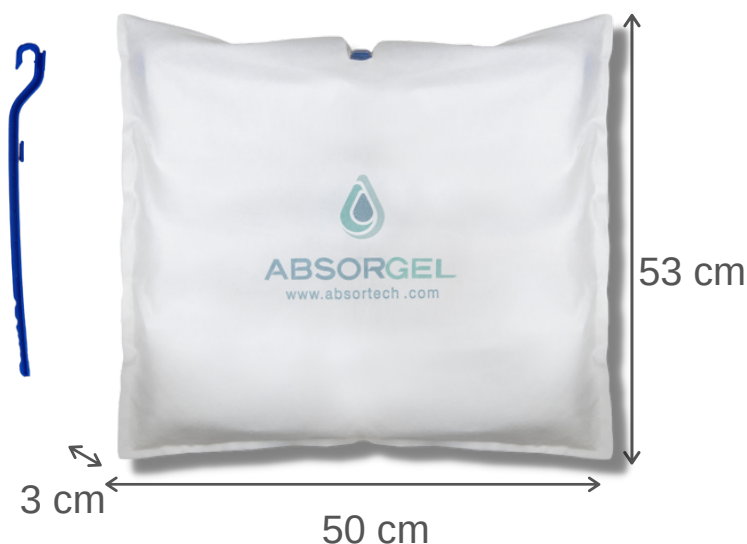

Product Specifications

Dimensions: 530mm (l), 500mm (w), 30mm (d)

Working temperature: -20°C to +80°C

Active Ingredient: Calcium Chloride (CAS registry number 10043-52-4)

DMF Free - RoHS compliant - REACH compliant



Installation



Absorgel Max effectively protects:

- ✓ Agricultural products
- ✓ High-volume and bulk loaded goods
- ✓ High-stacked pallets

Units needed

Approximate number of Absorgel Max units needed to protect your cargo:

Container Size	Short Distance, < 30 days		Long Distance, > 60 days	
	Dry Cargo	Moist Cargo	Dry Cargo	Moist Cargo
20"	3	4	4	5
40"	5	6	6	7

The quantity needed will vary depending on various factors such as shipment time, climatic conditions during the shipment, air volume in the container, type of packaging used, cargo type etc.

Pro-Ex can assist you to calculate the exact number of Absorgel Max units you will need in your unique circumstances.





Installation Instructions

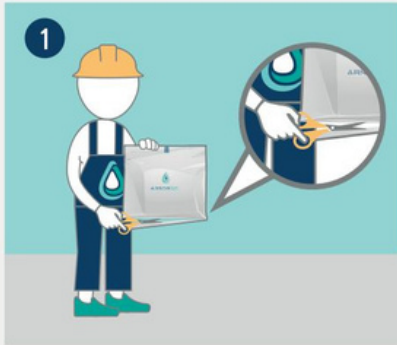

1 Activate the AbsorGel by opening the transparent outer plastic packing and taking out the AbsorGel. Be careful not to cut into the AbsorGel.

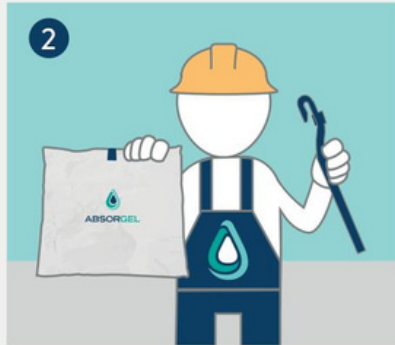

2 Take out the AbsorGel from the transparent plastic packaging. Do not remove the non-woven layer.

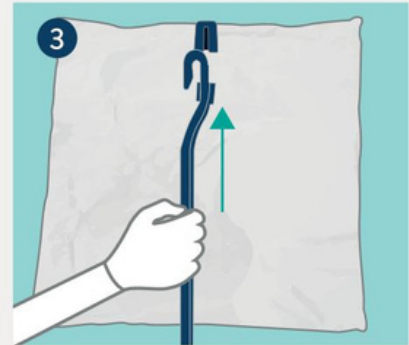

3 Fit the hook on the back (non-printed side) by pushing it up into the slot.

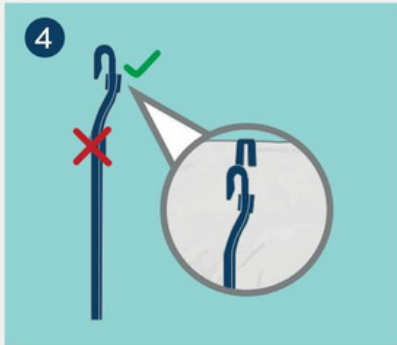

4 Always use the top position holder of the hook to hang AbsorGel Max.

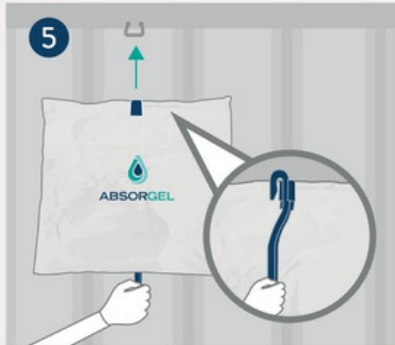

5 Use the hook to reach the container lashing ring.



6 Hang the AbsorGel on the container lashing ring.

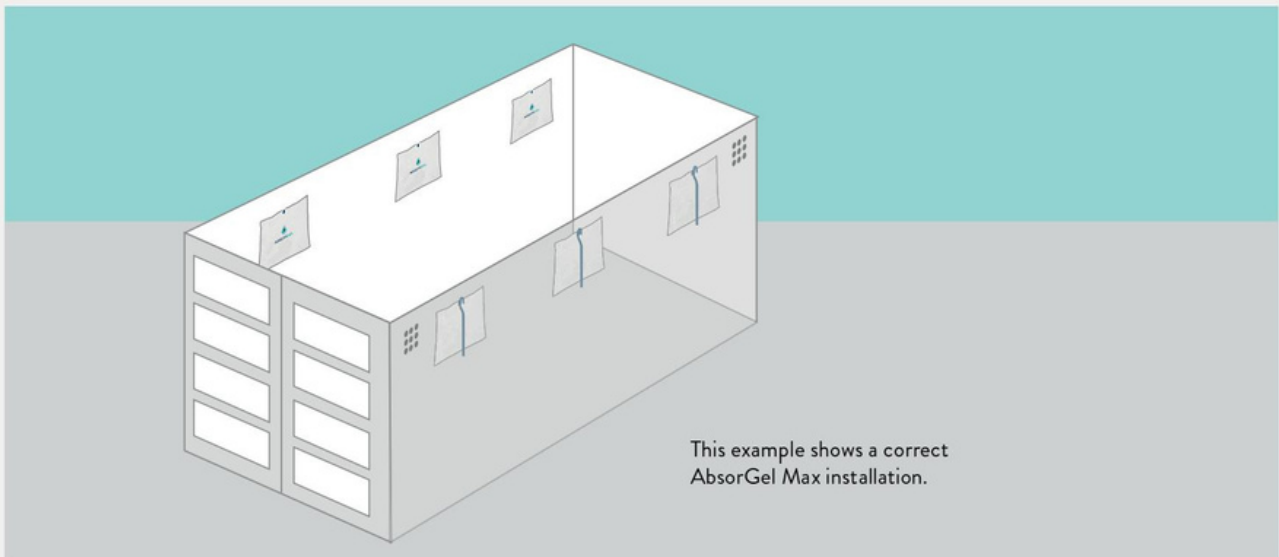

This example shows a correct AbsorGel Max installation.

Disposal

Absorgel Max is a single-use product and can be disposed as regular waste. The calcium chloride and gelling agent are non-toxic and the polyethylene (PE) and polypropylene (PE) plastic hook are recyclable.

